

Combi Corporation

Combi Baby Car Seat User Guide

(This user guide should be kept in the rear pocket of car seat backrest)

Neosis First 2.5EG Neosis First 2.5S

- For safety of your children, read this guide carefully and use the baby car seat accordingly after fully understanding the instructions.
- If not properly installed, baby car seat will not function as it is designed to and may cause danger. Do secure (fix) the car seat firm in your vehicle.
- Keep this user guide in the rear pocket of car seat backrest (See P.8).



Babies below 9 kg in weight must be seated facing backward against driving direction. Facing forward is extremely dangerous.

Before using this product

Thank you for your patronage with our baby car seat. For proper use, read this user guide carefully.

Baby car seats are designed to reduce the injury to children in case of traffic accidents. However, it is not necessarily a guarantee that these seats can completely protect children from injury. When in use, children are to be accompanied by adults.

Product application

This product is suitable for children who meet the following conditions.

- Weight : Children weighing below 18 kg (age range: newborns* ~ around 4 years old)
Less than 7 kg → Must use inner cover.
Less than 9 kg → Must be seated facing backward against driving direction.
9kg ~ Less than 10kg → Can be seated facing backward or forward against driving direction
Above 10 kg → Must be seated facing forward.

- Height* : Children whose chins are 3 cm away from the sub belt cover, and whose heads do not protrude out of the backrest.

* Newborns refer to newly born babies weighing above 2.5 kg and carried for above 37 weeks during pregnancy stage.

Inapplicable vehicle seats

Inapplicable vehicle seats include but not limited to the following list. Do not use baby car seat whenever it cannot be firmly installed on the vehicle seat.

- Seats without safety belts;



- Seats with only 2-point belts;



- Seats with belts extending from the middle of the seats, or Seat belts whose extension point is in front of the seat belt insertion area of the baby car seat.



- Vehicle seat with passive seatbelts. This seatbelt automatically buckles the driver when closing the door after seated.



- Vehicle seats that are installed sideways or backward to the forward direction.



For safe use of our product

Guidance is continued in next page

- Never install the car seat on seats with airbag. Vehicle seats with only side-airbag are applicable however.



- Vehicle seat with a sitting depth of less than 43cm.



- Vehicle seats with a mounded middle portion which cannot secure the child seat.





- Vehicle seat of which the installing width* of seat belt is less than 35cm.

※Refer to the distance from where the seat belt touches at the child seat to the buckle of the seat belt.



Labels such as [DANGER] [WARNING] [CAUTION] categorize the severity level of expected harm and damage caused by non-compliance to these instructions. These labels are very important and should be followed properly.

Labels	Contents of the labels.
 DANGER	Improper operation will directly cause death or severe damage.
 WARNING	Improper operation will possibly cause death or severe damage.
 CAUTION	Improper operation may cause injury or damage of the product.

- Bucket seat in extreme shape.



Baby car seat can be installed either on the front seats or the back seats of your vehicle. However, it is highly recommended to have it installed on the back seat.

For safe use of our product

Guidance is continued in next page

⚠ DANGER

- Never seat a child that does not satisfy the applicable conditions or on insufficient condition of vehicle seat.



- Never install the baby car seat on seats with an airbag. In case of collision, the airbag will expose the baby car seat to major impact which is extremely dangerous. Vehicle seats with only side-airbag are applicable however.



- Do not allow children to stand, squat, stoop or sit upright in the car seat. When seating the baby, check if safety belts are correctly installed; right and left buckles are fastened properly; and the indicator has turned green.



- Never use the baby car seat if it cannot be securely fixed as indicated in this user guide due to the type of seatbelt or seat of your vehicle.



- Always fix the baby-car seat with the vehicle seatbelt when installing in the vehicle. Never fix with a rope, string or other items than the seatbelt.



⚠ WARNING

- For forward facing mode -- make sure that the angle adjuster is at stored position. For backward facing mode -- according to need, use the angle adjuster to install the child seat at the safest angle.

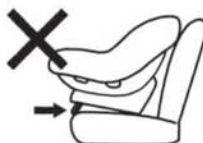

For forward facing mode



For backward facing mode

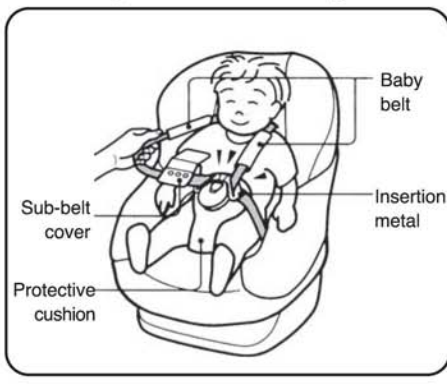

For safe use of our product

Guidance is continued in next page

⚠ WARNING

Improper operation of the baby car seat may result in malfunctioning and may cause danger.

- Keep the baby belt fit tightly. Any looseness may get caught around the neck which may be the cause of suffocation.
 - Make sure to adjust the baby belt to a suitable length (Refer to P.12 for adjustment).



- Stop using it if there is any rift or damage on the seat belt.



- Make sure to use the most reclined angle when using backward facing mode. It cannot fix firmly with upright angle.



- Stop using the child seat if the baby belt is damaged.



- Always use inner cushion (for head and for seat) and backward facing position for less than 7kg child.



- Your child may accidentally press the buckle button and release the buckle. It is important that you periodically check that the child belt is securely fastened. Any looseness may get caught around the neck which may be the cause of suffocation.



- When knocked or made to fall to the ground, this product should not be used again, even if the knock is one-off and no physical damage is seen.



For Safe Use of Our Product

WARNING

- Never leave your child in the vehicle unattended. In hot days the cabin temperature may rise and endanger the child to heat strokes or dehydration. It may also lead to unexpected accidents. An adult should accompany a child in a vehicle at all times.



The following usages may cause danger to other passengers.

- Always keep the child seat securely fixed with the vehicle seatbelt, even if it is not in use.



- If it's difficult to see the side mirror, please re-set the child seat to back seat.



- Make sure to use the belt lock lever to secure the seat belt after the baby is seated.



- Do not install the child seat on a seat if installation inhibits proper and safe use of the gearshift or hand-brake etc.



- Do not install on the front seat of a 2-door or 3-door vehicle in case it may obstruct passengers from getting out the vehicle in emergency.



For safe use of our product

Guidance is continued in next page

⚠ REGULAR INSPECTION

To ensure the car seat to function well, the following inspection procedures must be conducted before traveling.

Check if the baby belt is installed in the correct shoulder strap insertion outlet.

Check if the insert buckle is firmly fastened and the indicator turns green.

When the dual-shoulder straps are fastened on the baby, check the tightness. (It can be adjusted by pulling the adjustable strap).

Check if baby car seat is firmly secured on the vehicle seat (Check by moving the seat back and forth)

Make sure the baby belt is not twisted or loose.

Check if the vehicle belt is buckled firmly.

Make sure to use the belt lock to secure the seat belt after the baby is seated.

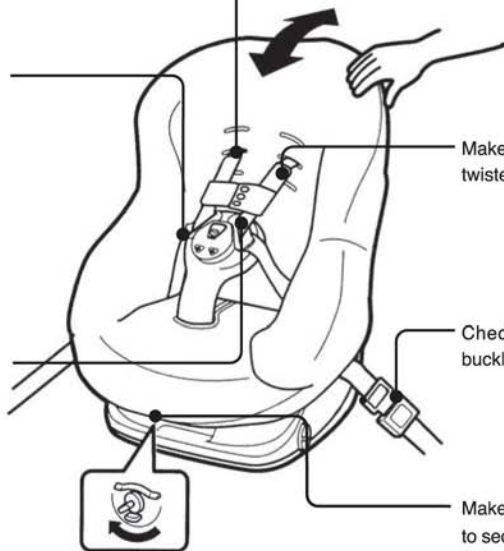

⚠ EMERGENCY EXIT

In case of emergency, such as accidents, press the button to release the baby belt from the chest buckle, and remove the baby from the vehicle immediately.



For safe use of our product

⚠ CAUTION

- Leaving the child seat exposed to direct sunlight will cause the child seat, buckle, locking clip and other parts to get excessively hot. Always touch and check all parts before seating your child. Failure to do so may cause burns. In the summer or on hot days park in shade or cover the child seat with a cover (cloth, etc.).



- Never modify the baby car seat of handle it in ways not described in this manual.



- To avoid unstable fixture, never install the baby car seat with a cushion in between the vehicle seat.



- Never adjust or seat the baby car seat while driving. Make sure that passenger children do not play with the baby car seat.



- Do not use the locking clip in other purpose than installing the child seat.

- Do not expose the child seat to place that easily get wet.



- Never use the baby car seat for purposes other than a car seat. This seat is designed for use in car only.



- Do not use the baby car seat without the cushions and covers. Do not replace them with other cushions. It may not be able to protect the baby.



- Make sure the baby car seat is not jammed in between doors or the sliding parts of vehicle seats.



- Do not leave things unsecured in the car. Things may fall off onto the baby when the car is in motion.



Names of components (Please make sure no component is missing before usage.)

FRONT

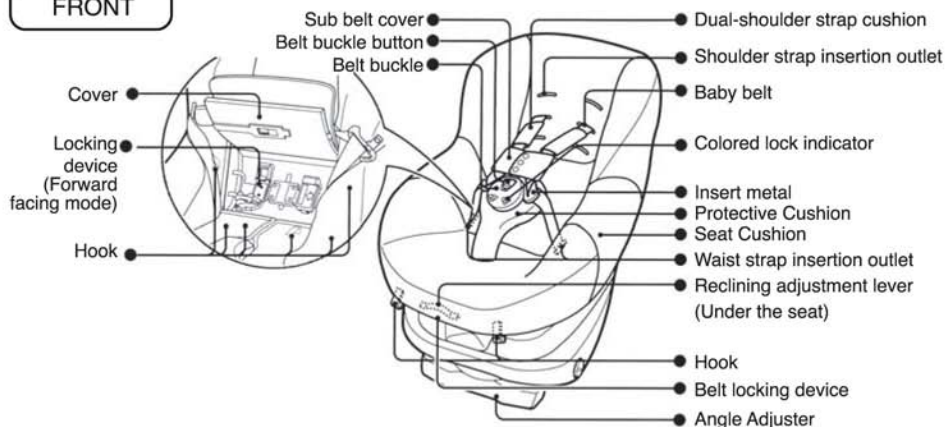

- Locking clip (For both EG/S models).
- Locking clip is an important component to the baby car seat. After use please keep it together with this user guide in the rear pocket of the backrest. (Please refer to P.18 for the usage of locking clip)

SIDE AND BACK

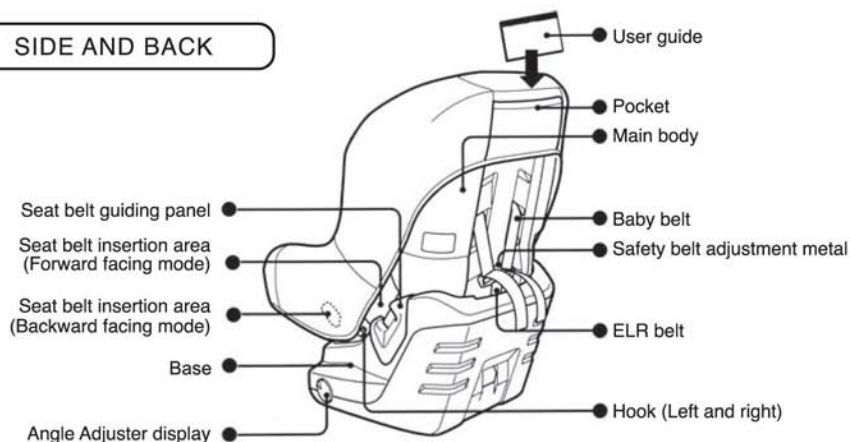

● Inner cushion

• S Type

For head

For seat



• EG Type

For head

For seat



Before installing to your vehicle

This part describes how to determine the installation direction.

Our baby car seat can be used in 3 ways according to different growing stages of children.

For baby weighing below 7 kg.
Newborns* ~ around 4 months old

- Face backward against driving direction. (Do not use forward facing mode)
- Use inner cushion. (Both for head and seat)
- Use sub belt cover.
- Make sure the seat is at most reclined angle.



※ Newborns are referred to newly born infants weighing above 2.5 Kg and carried for above 37 weeks.

Weighing from 7 kg to 10 kg
4 months old to 1 year old

- Face backward against driving direction. (For babies below 9kg do not use forward facing mode.)
- Do not use inner cushion. (Neither for head or for seat)
- Use sub belt cover.



※ Babies weighing between 9 kg and 10 kg can be seated facing either forward or backward.

Weighing from 9kg to 18kg
1 to 4 years old

- Facing forward against driving direction
- Never use inner cushion and sub belt cover.
- Can use reclining function.



Seating the baby

Guidance is continued in next page

Please adjust the car seat to fit the baby before seating.

- Do not use swaddling clothes, and babies should not wear clothes in which hands and legs cannot be separated.



- Do not wrap the baby with towels.
- Make sure the baby is not wearing oversized clothes.
- Make sure the baby sits correctly. Incorrect poses as shown below are dangerous.



⚠ WARNING

- 1 Press the belt buckle button and release the insert metal. Pull the protective cushion towards the front and seat the baby. Put the arms of the baby through the baby belt and resume the insert metal to the belt buckle until a sound "click" is heard.

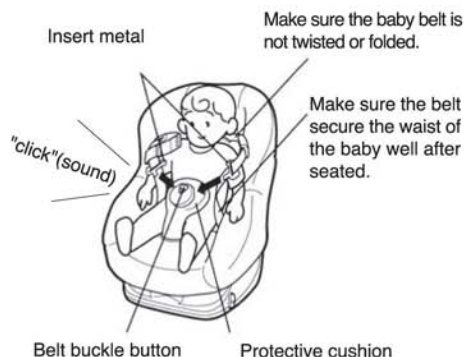

Seating the baby

- 2** Pull the insert metal slightly to make sure the lock indicator has changed to green.

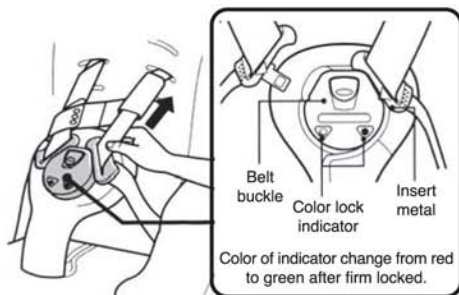

- Press the belt buckle button and the insert metal will be released.
- Make sure to secure the insert metal even if the baby is not on the seat.



- 3** When seating facing backward, make sure to use the sub belt cover.

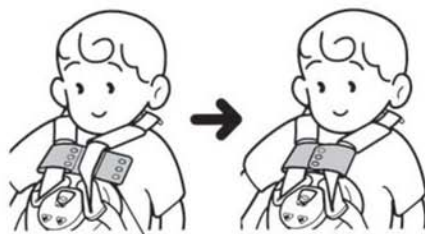

Sub belt cover



- Make sure the insert metals are completely buckled and the indicator turns to green. Unsecured buckle will endanger the baby in accidents, and the baby belt may tangle the baby's neck and suffocate it.

Use of baby belt locking device

After seating the baby make sure to lock the seat belt by using the locking device. Otherwise, the baby may get loose from the seat and fall off.

- 1** Press and hold the button below the locking device, and turn the lever clockwise to lock the belt.

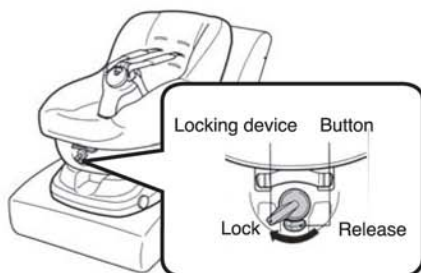

※ Do not turn the lever beyond any limited directions.



- Use the locking device both in forward and backward facing mode.
- In case it is difficult to operate, recline the backrest of the seat or press the child seat in ① direction to operate.



- It is dangerous to leave the baby sitting in the car seat without locking the belt. The baby may fall off from the seat.

Use of the shoulder strap insertion outlet

The shoulder strap extension point has to be adjusted according to the height of baby. By using different shoulder strap insertion outlets, the extension point should always be just above the baby's shoulders. (The shoulder strap is set at the lowest position in the sales package)

For new born babies usage

Pay particular attention to the sections [Use of The Shoulder Strap Insertion Outlet] and [Length Adjustment of The Baby Belt] when the seat is used for babies below 7 kg.

! DANGER

- Make sure the chosen shoulder strap insertion outlet is correct and the length of the baby belt is suitable.
- Make sure baby belt is correctly fastened.
- Make sure to use the sub belt cover.
- * If the baby belt is not properly set, the baby may be thrown off from the seat when accident occurs.

! CAUTION

- Do not use the seat continuously for more than one hour.

- 1 Put the baby in the baby car seat and check if the shoulder strap insertion outlet has to be adjusted.



! WARNING

- Pull the baby belt through the shoulder strap insertion outlet that is just above the baby's shoulders.



- If installed incorrectly, the baby belt may fall off from the shoulders and cannot well protect the baby from accidents.
- Please use insertion outlets of same level for both sides.

- 2 Resume the baby belt to the safety belt adjustment metal.

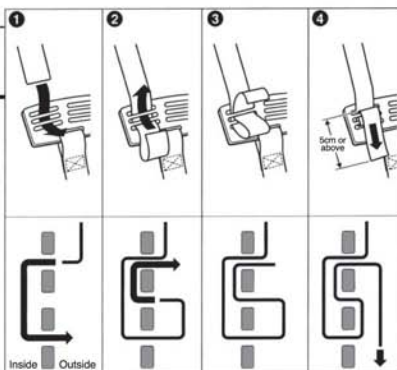
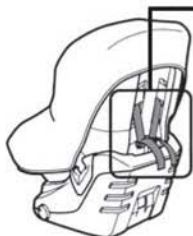

Baby belt length adjustment method

After seating the baby, adjust the length of the baby belt to fit the body of the baby accordingly.

WARNING

- To avoid the baby belt slipping out from the adjustment metal, make sure the leave at least 5cm at the end of the baby belt.
- As shown in the diagram set the adjustment metal at around 5cm from the extended belt.
- Loose baby belt may tangle the baby's neck and suffocate it.

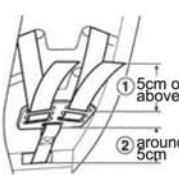

- Make sure to leave proper space between the baby and the baby belt. For reference, the space should be large enough for an adult's palm to pass through.



To shorten the baby belt

Pull from the direction ① and then tighten by pulling from direction ②.



To lengthen the baby belt

Loosen the baby belt by pulling from the direction ③ and then ④.

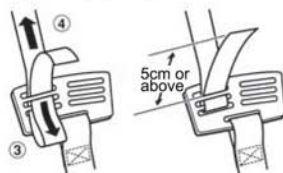

Use of reclining function (Only for forward facing mode)

This feature is designed for an easy reclining of the baby car seat particularly when the baby is sleeping, and is not available for backward facing mode.

Do not use the reclining function when facing backward.



Use the most reclined angle only in backward facing mode.

- CAUTION**

- The adjustment of reclining must be done when the car is not in motion.

- If it is difficult to use the reclining function after installation, turn down the backrest of the vehicle seat for 1 or 2 pitches before using the reclining function of the baby car seat. Restore the vehicle seat to normal afterwards.
- The reclining function may not work properly for vehicle seats with non-adjustable backrest, or for certain specially designed vehicle seats with different shapes.

- 1 As the diagram shows, lift the reclining adjustment lever. Adjust the reclining angle of the seat (3 pitches).
- 2 When your hand moves away from the adjustment lever, move the main body of the seat back and forth to check if the seat is locked firmly at the selected pitch.

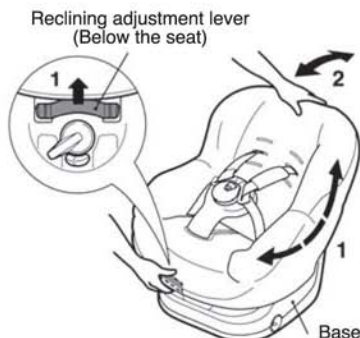

Use of inner cushion (For babies below 7 Kg)

Guidance is continued in next page

Inner cushion is used to protect the babies. Use the inner cushion for babies below 7kg. Remove the inner cover when the baby exceeds 7 kg.



- Inner cushion can only be used for babies below 7 kg. It may cause danger to use it for babies above 7kg in weight.
- Both the inner cushions for head and for seat must be used together.
- For proper use, please read this part carefully before installing the inner cushion.



- Do not leave the removed inner cushion in your car.
- Do not hold the inner cushion when moving the baby car seat.

Prohibit for long time usage

Do not use the seat continuously for more than one hour. Continuous use may lead to unnecessary burden to babies. Make sure to let the baby rest once in an hour.

Accompanying passengers

It is suggested passengers other than the driver should travel along with and take care of the child. In case there is no other passenger, the driver should pay as much attention as he can to the child (e.g. when the vehicle is not in motion).

Installation method of inner cushion
Install the belt as the below.

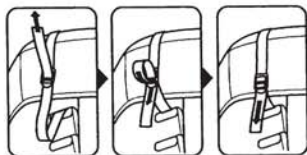

1 Inner cushion should be used for babies below 7kg.



Sub belt cover should be used

2 For babies above 7kg, please remove the inner cushion when use.



Sub belt cover must be used for backward facing mode



- In case it is too tight after installing the inner cushion, please operate as below mentioned.

Use of inner cushion (For babies below 7 Kg)

Note the followings when using the inner cushion

● When the head part becomes too tight

When the inner cushion for back makes the head part become too tight, please install the inner cushion to the upper insert outlet. (If it is still too tight, please remove the Urethane Foam inside the cushion before use.)

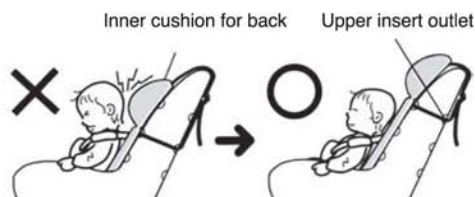

● Adjust the baby belt to suitable length

Adjust the baby belt to suitable length and use together with the sub belt cover.

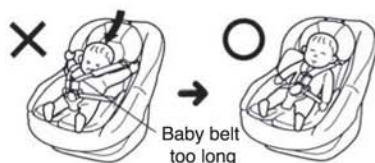

● Correct sitting position

Make sure the baby is sitting in correction position.

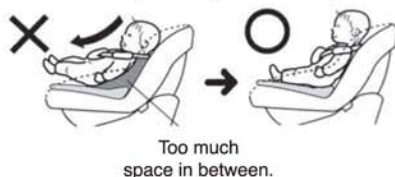

Installation to the vehicle

This part describes [Various Types of Seat Belts and Important Notes for Installation] and the [Installation of the Baby Car Seat].

* The baby car seat may not be applicable to certain vehicle seats. See page 1 for details.*



- Insecure baby car seat is extremely dangerous. If the baby car seat cannot be firmly secured, try to install it on other seats.
- Use only safety belts to install the baby car seat.
- The baby car seat must not be installed to vehicle seats equipped with safety airbags. As safety airbags generate tremendous force when knocked, it may cause danger to the babies.
※ This limitation is not applied to vehicles with only side airbags.



- Do not install the baby car seat to seat whose safety belt is rift or damaged.
- If installation to the seat next to the driver blocks the side mirror, install it to the back seats.
- The baby car seat must always be secured with safety belts no matter it is in use or not.
- If installation to the seat next to the driver causes disturbance to the gear or the handbrake, install it to the back seats.
- For 2-door or 3-door vehicle, do not install to the seat next to the driver if there are passengers in the back seats. Keep clear of the exit in case of emergency or accidents

Various types of vehicle safety belts and important notes for installation

Installation of baby car seat varies according to the types of vehicle belts.

	Different Types of Safety Belts (Belt models)	Characteristics (How to distinguish)	Important notes for installation	
			Backward facing mode (For baby below 10kg)	Forward facing mode (For baby between 9-18kg)
<div>  <p>DANGER</p> </div> <ul style="list-style-type: none"> ● Make sure to install the baby car seat onto vehicle seats with 3-point safety belts. ● Do not install it onto seats with 2-point safety belts. 	Safety belt with ELR (Emergency Locking Retractor Safety Belt, with retracting device)	With a slight pull, the belt is flexible. With a hard pull, the belt is locked.	Must use the locking clip.	Use the main body locking device
	Safety belt with the function of retaining baby car seat. (Safety belts with AELR (Automatic Emergency Locking Retractor))	When completely unfastened, the belt will automatically lock up when retracts and can't be extended any further. (The locking function is disabled when the belt retracts completely.)	Use the locking clip in case the seat cannot be firmly secured	Use the main body locking device
	Manual safety belts	Without automatic retracting device	Adjust the seat belt to secure the car seat. Use the locking clip in cases the seat cannot be firmly secured.	No need to use the main body locking device. Simply adjust the seat belt to secure the car seat.
	Safety belts with Non-Locking Retractor	Retract device without locking function	Use the seat belt to secure the car seat. No need to use locking clip.	No need to use the main body locking device. Simply adjust the seat belt to secure the car seat.
	Safety belts with Automatic Locking Retractor	The safety belt locks if sudden stop occurs during unfastening.		

Before installing to your vehicle in backward facing mode (For baby below 10kg)

- ① For baby below 10kg please make sure to use in backward facing mode. Especially for baby below 9kg, using in forward facing mode is dangerous.
- ② Detach the inner cushion for seat before installation.
- ③ Make sure to use the sub belt cover.
- ④ Set the seat at the most reclined angle.
- ⑤ Park the vehicle on flat ground before installation.
- ⑥ Put the baby seat onto the vehicle seat facing backward against driving direction.



- 

WARNING
- Make sure the baby seat is at the most reclined angle.
 - For baby below 7kg, inner cushion must be used.

Use of angle control system

On some specially shaped vehicle seats the baby seat may not be able to install securely. The Angle Control System is then used to adjust the angle of the installation.

- ⚠ DANGER**
- Do not use the child car seat when the angle checker indicates "dangerous",
 - Angle adjuster can only be used in backward facing mode. According to the angle adjuster display and the weight of the baby, install the baby seat properly with the angle adjuster opened.
 - Make sure to use the angle checker to check if the installation angle applicable to the weight of the baby.
 - Do not use the angle adjuster in forward facing mode.

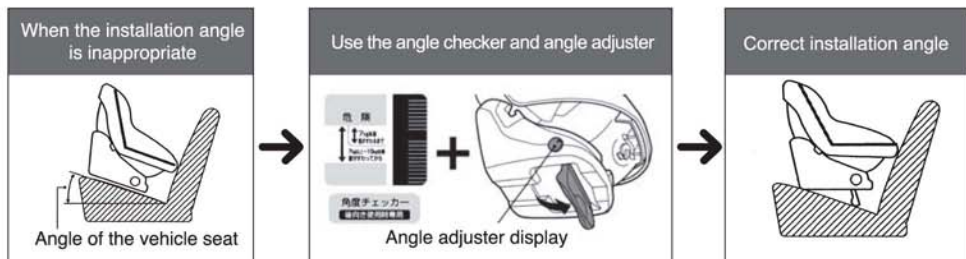

1 Pull out the angle adjuster below the seat base. The angle adjuster display should change from 1 to 2.

2 Put the child car seat on the vehicle seat again, and use the angle checker to check if the installation angle is appropriate.

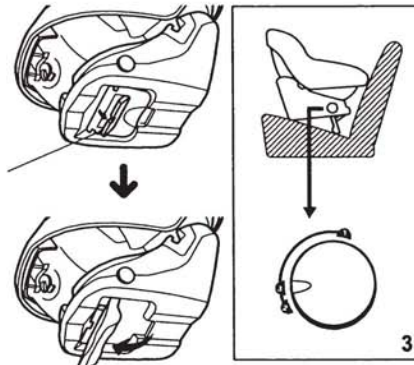
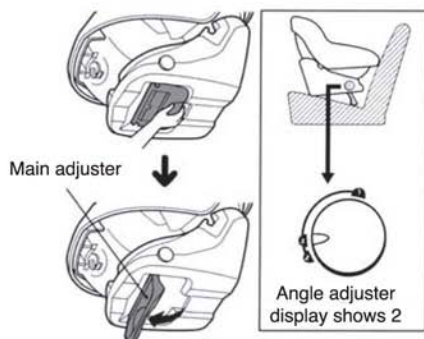

- ⚠ CAUTION**
- Mind your hands or fingers.

Installation to the vehicle (Backward facing mode)

Guidance is continued in next page

- 1 Pull the seat belt through the insertion area for backward facing mode.

⚠ DANGER

- The insertion area of the seat belt is different in forward and backward facing mode.

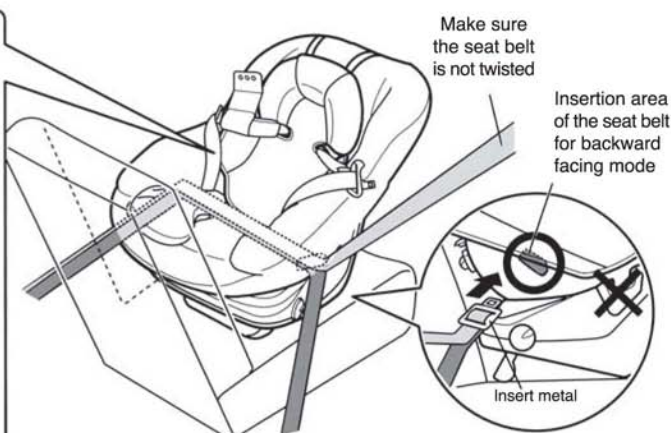
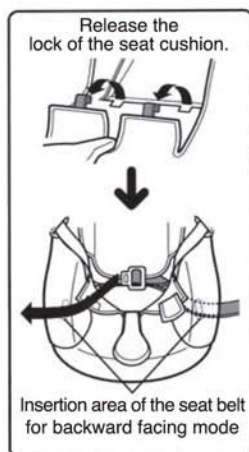

- 2 Fasten the insert metal into the insertion buckle of the vehicle. Install the locking clip as demonstrated if required for certain types of seat belt.

※ Try to install the locking clip in a lower position than the seat belt insert area for backward facing mode.

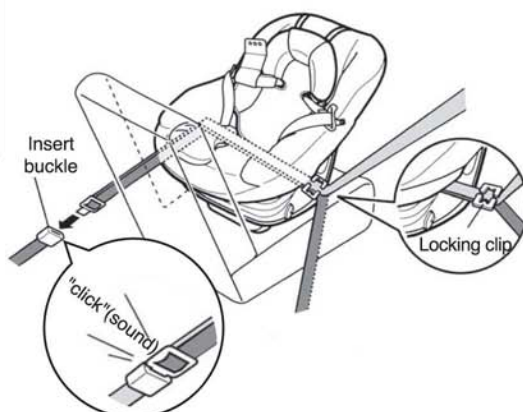

- 3 Put back the seat cushion accordingly.



- 4 Make sure to check if the seat is firmly secured according to the chapter inspection procedures after installation (See P.19).

Refer to P.22 & P.25 if it is still unstable after installation.

Installation to the vehicle (Backward facing mode)

Using method of the locking clip - A

- 1** Pull the seat belt through the insertion area.

- 2** Hold the shoulder belt and the lap belt as demonstrated and release the insertion buckle.

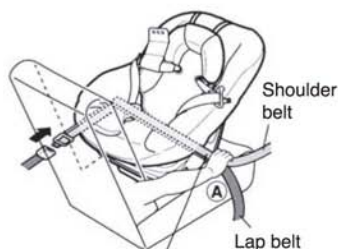

Position of the locking clip

- 3** ① Put the shoulder belt onto the lap belt and attach the locking clip.

- ② As demonstrated, secure the locking clip at 3~5cm away from the insert metal.

- ③ Tighten the shoulder belt and lap belt.

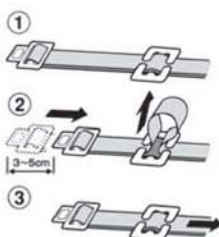

- 4** ① Pull the seat belt through the insertion area again.

- ② Add on your weight

- ③ Fasten the insert metal into the buckle.

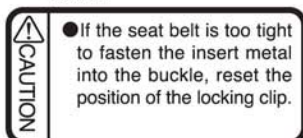

CAUTION

● If the seat belt is too tight to fasten the insert metal into the buckle, reset the position of the locking clip.

Using method of the locking clip - B

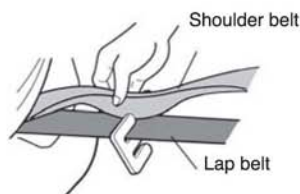

- ① As demonstrated, put together the shoulder belt and the lap belt and attach to the locking clip.

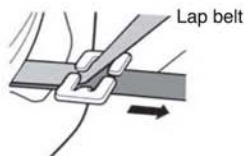

- ② Put the lap belt through another part of the locking clip.

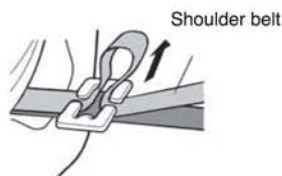

- ③ Make a circle using the shoulder belt as demonstrated and out put through the locking clip

Add on your body weight.

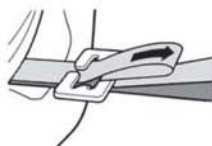

- ④ Put from the upper part of the circle to secure it.

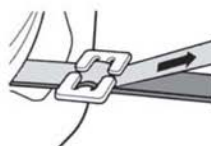

- ⑤ After it is firmly secure, tighten the upper belt in the demonstrated direction.

Inspection procedures after installation (Backward facing mode)

After installation, follow the steps below and inspect if the baby car seat is firmly secured.



- ① Make sure the vehicle belt insert metal is correctly fastened.
- ② For baby below 7kg make sure to use the inner cushion.
- ③ Make sure to use the sub belt cover.
- ④ Make sure the backrest is well tightened against the back of baby car seat.
- ⑤ Make sure the angle checker shows a correct indication.
- ⑥ Make sure the seat belt does not get loose because of the weight of the baby after seating.
 - ※ There are some cases that the weight of baby may cause the seat to sink and hence loosen the seat belt.
- ⑦ After seating make sure to use the belt locking device to lock the belt.
- ⑧ Make sure the insert metal is already fastened into the belt buckle and turned green color.



● Follow the steps accordingly. If the baby car seat cannot be firmly secured, try to install it again or try to install the other seat. Unsecured baby car seat is dangerous.

Before installing to your vehicle in forward facing mode (For baby weighing 9~18 kg)

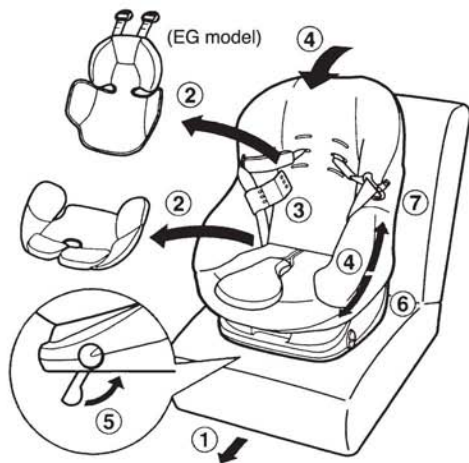

- ① Forward facing mode is only applicable to baby weighing 9~18kg.
- ② Remove inner cushion to use.
- ③ Remove the sub belt cover.
- ④ Resume the backrest of the vehicle seat if it is reclined.
- ⑤ Do not use angle adjuster in forward facing mode.
- ⑥ Place the baby car seat onto the vehicle seat firmly.
- ⑦ Make sure the end of the baby belt is not jammed in between the seat and the base.



● Make sure the angle adjuster is closed while installing forward facing mode.

Installation to the vehicle (Forward facing mode)

Guidance is continued in next page

1 Open the cover

- ① Open up the seat cushion,
- ② press the lock button towards right, and
- ③ Lift the cover until a sound "click" is heard.

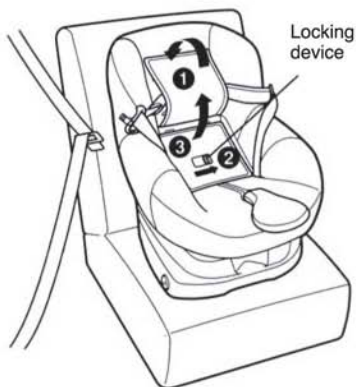

2 Open the locking device of both sides.

- ① Release the locking device from the end.
- ② Lift the first locking blade, and then
- ③ the second one.

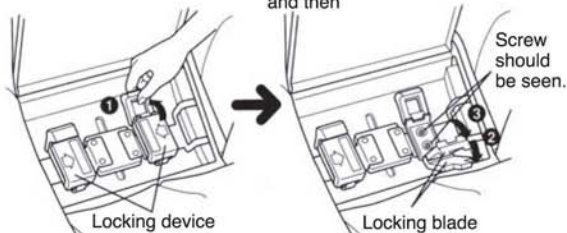

Owing to safety issue, the locking device is set a bit hard to release. In such case operate as demonstrated to release the blade.

Lift both 4 locking blades in total



3 Pull the seat belt through the baby car seat

- ① Pull the seat belt through the insertion area for forward facing mode.
- ② Put the seat belt onto the opened locking device.
- ③ Pull from the other end.
- ④ Fasten to the belt buckle.

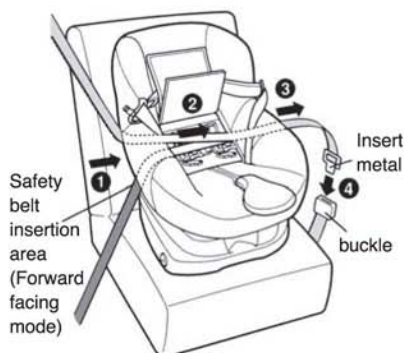

4 Put the seat belt onto the locking device.

- ① As demonstrated, put the lower belt below the second locking blade that is near to the buckle belt.
- ② Put the upper belt in between the first and second locking blade.
- ③ Lock the locking device again.

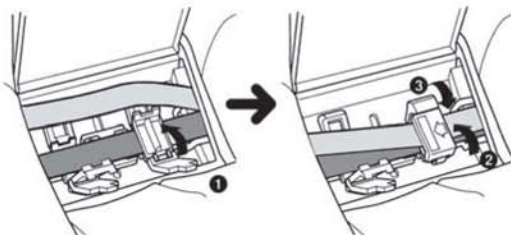

Owing to safety issue, the locking device is set a bit hard to lock. In such case operate as demonstrated to lock the blade.



※ Make sure to place the belt properly onto the locking device. Otherwise the locking device may be jammed and cannot be opened again.

Installation to the vehicle (Forward facing mode)

Guidance is continued in next page

5 Add on your weight to tighten the seat belt

- 1 Put your knee onto the seat.
- 2 Get hold of the shoulder belt just above the belt buckle and pull hard.
- 3 At the same time pull hard of the lap belt at the other side.
- 4 As demonstrated, tighten 2 and also 3 at the same time to make sure 2 is tightened properly.

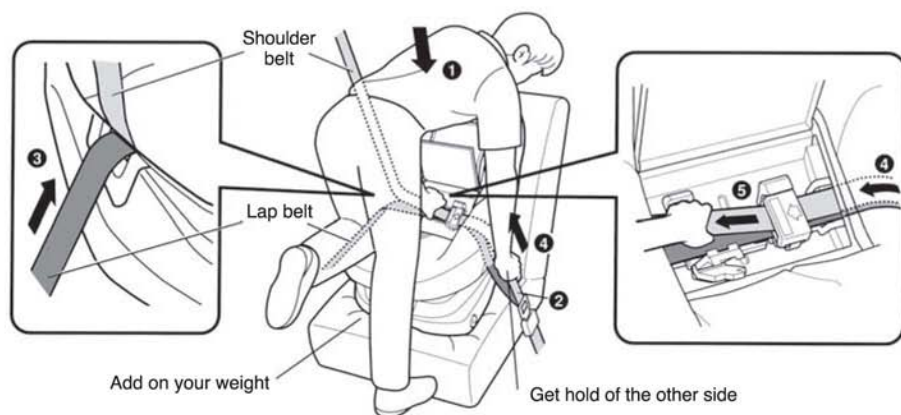

6 Lock the locking device at the other side.

- 1 As demonstrated put the lower belt below the second locking blade.
- 2 Put the upper belt in between the first and second locking blade, and 3 resume the locking device again.

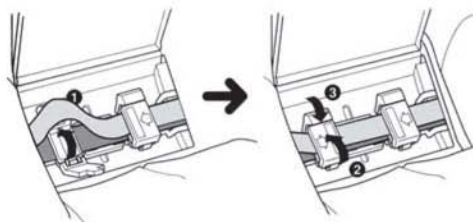

7 Close the cover

- 1 Close the cover until it is firmly locked.
- 2 Resume the seat cushion.

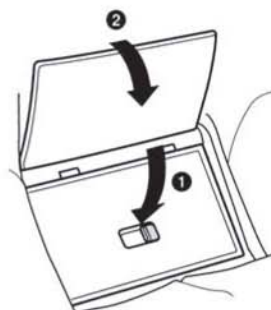

- Make sure to check if the seat is firmly secured according to the chapter inspection procedures after installation (See P.22)

Inspection procedures after installation (Forward facing mode)

After installation, follow the steps below and inspect if the baby car seat is firmly secured.



- ① Make sure the vehicle belt insert metal is correctly fastened.
- ② Make sure the backrest is tightly abutting against the back of baby car seat. Try to move the base back and forth, and the baby car seat should not dislocate for more than 3cm.
- ③ Make sure the seat belt does not get loose because of the weight of the baby after seating.
 - ※ There are some cases that the weight of baby may cause the seat to sink and hence loosen the seat belt.
- ④ Make sure the angle adjuster display shows 1.
- ⑤ Make sure to remove all inner cushion.
- ⑥ Make sure the cover is closed firmly.
- ⑦ Make sure the belt locking device to lock the seat belt.
- ⑧ Make sure the insert metal is fastened to the belt buckle and the color indicator has turned to green.



- Follow the steps accordingly. If the baby car seat cannot be firmly secured, try to install it again. Unsecured baby car seat is dangerous.
- The belt locking device may not be applicable to some kind of seat belt. In such case try to install the baby car seat onto other vehicle seats.

In case the insertion buckle of the vehicle safety belt is unstable or unsecured

Do operate as shown in the diagram if the insertion buckle of the vehicle seat cannot be secured.

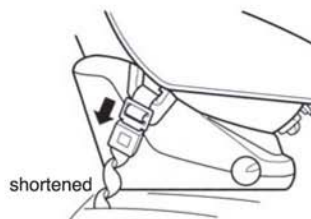
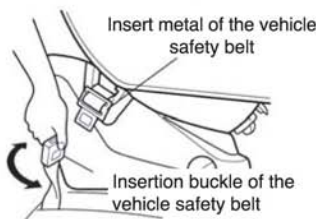

- 1** Release the insertion buckle. Get hold of the buckle, and try to shorten it by coiling to 1-3 loops.
- 2** Fasten the insert metal of the vehicle safety belt back to the insertion buckle.

※ If the insertion buckle of the vehicle safety belt (shorter belt) still remains unsecured, please use our adjustment pad which is sold separately. This adjustment pad, however, cannot be used together with the attached angle adjustment pad.



- Do not install the baby car seat if the insertion buckle is unsecured. Otherwise the car seat may not function as it should and may cause danger.

Removing the seat cushion

- ❶ Remove the inner cushion.
- ❷ Release the baby belt from the adjustment metal at the back of the baby car seat.
- ❸ Release the shoulder strap cover, insert metal and the protective cushion cover.
- ❹ Release the 4 hooks at the side of the seat cushion
- ❺ Release the 6 hooks at the inner side
- ❻ Remove the seat cushion from the protective cushion buckle. Pull out the baby belt and lift it up.

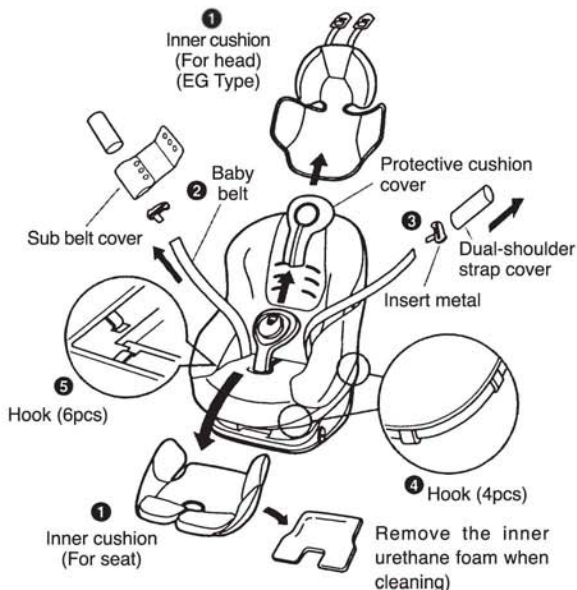

- ❏ Always fasten the insert metal for easy seating.

Restoring the seat cushion

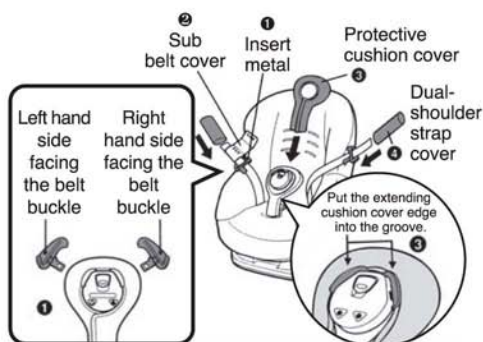
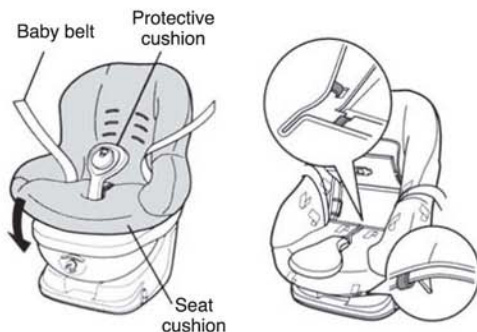

- ❶ Put the seat close to the backrest of the main body, pull the belt buckle through the outlet of the protective cushion, lay down the seat. Remember not to twist the baby belt. Pull it outward.
- ❷ Put the 10 hooks back to the body.
- ❸ Put back the seat cushion and fasten back the insert metal. Beware not to mix up the left one with the right.
 - ❶ Restore the sub belt cover
 - ❷ Restore the protective cushion cover.
 - ❸ Put back the dual-shoulder strap cover.

Maintenance

Print to note when washing the seat cushion, shoulder strap cover, protective cushion cover and inner cushion.

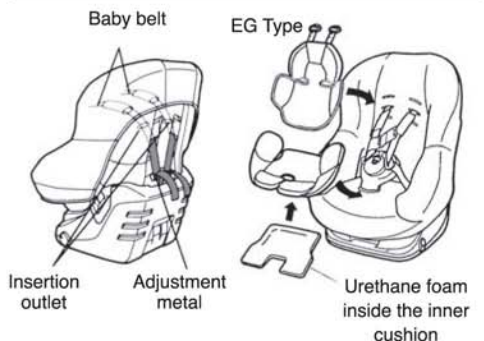

4 Pull the baby belt through the insertion outlet and secure back to the adjustment metal. (See P.11-12)

5 Restore the inner cushion.

	For hand washing, use warm water up to 30°C
	Do not use bleach.
	Do not iron.
	Do not use dry cleaning
	Light squeezing.
	Flat dry at cool place.

※ Please use detergent which does not contain fluorescent brightener.

Maintenance of the main body and baby belt

Simply wipe with a piece of wrung wet cloth, or use diluted neutral detergent for cleaning. After cleaning, cool dry

- WARNING**
- Do not use undiluted detergent, gasoline or other organic solvents when cleaning. Otherwise it may cause damage to the main body or the baby belt.

Storage

- User Guide: Always keep in the pocket at the back of the backrest.
- Locking Clip: Always keep in the pocket at the back of the backrest.
- Main Body: When the child car seat will not be in use for a period of time, uninstall it and store in shaded place clear from children.

In this case...

What to do if the baby belt is jammed?

- From the front side of the seat

- 1 Pull the baby belt towards your side
- 2 As demonstrated restore the belt back slowly.
- 3 Try to pull the baby belt again slowly.

1 Pull hard

3 Pull slowly

2 Restore the baby belt

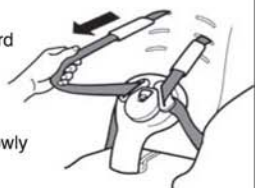

Effective ways to secure the baby car seat

- When installed on back seat in backward facing mode.

Slide back the front vehicle seat to lean against the backrest of the baby car seat. This can effectively secure baby car seat.



- When installed on the front seat in backward facing mode.

Do not install on vehicle seats with safety airbags. Also, it is highly recommended to have it installed on the back seats.

Slide the front vehicle seat forward until it lean against the dashboard. This can effectively secure the baby car seat.

※ This method may not work on some vehicle types.



- When installed on back seats that can be slide.

Slide forward the seat after successful installation. This can effectively secure the baby car seat.



- Do not install the baby car seat on vehicle seats with safety airbags, regardless of which facing mode it is using, since the impact of airbags may cause danger to babies. This limitation, however, is not applied to vehicles with side airbags.

Product specification

Product Specification NEOSIS FIRST 2.5EG

Size : (W)470x(D)550x(H)690mm
Weight : 11.5 KG
Materials : Main Body : Polypropylene
 Seat : Surface material : Polyester
 Inner cushion : Urethane foam

Product Specification NEOSIS FIRST 2.5S

Size : (W)470x(D)550x(H)690mm
Weight : 10.6 KG
Materials : Main Body : Polypropylene
 Seat : Surface material : Polyester
 Inner cushion : Urethane foam